



TEME HALL

Medium size conference and seminar space with beautiful views of the Malvern Hills. Perfect for training workshops, meetings and auctions.

Features

- ✓ Theatre style seating for 100
- ✓ Dining for 70
- ✓ 217 square metres of space
- ✓ Ample parking
- ✓ Natural daylight supported by additional lighting
- ✓ Disabled access
- ✓ WC
- ✓ Kitchen catering facilities

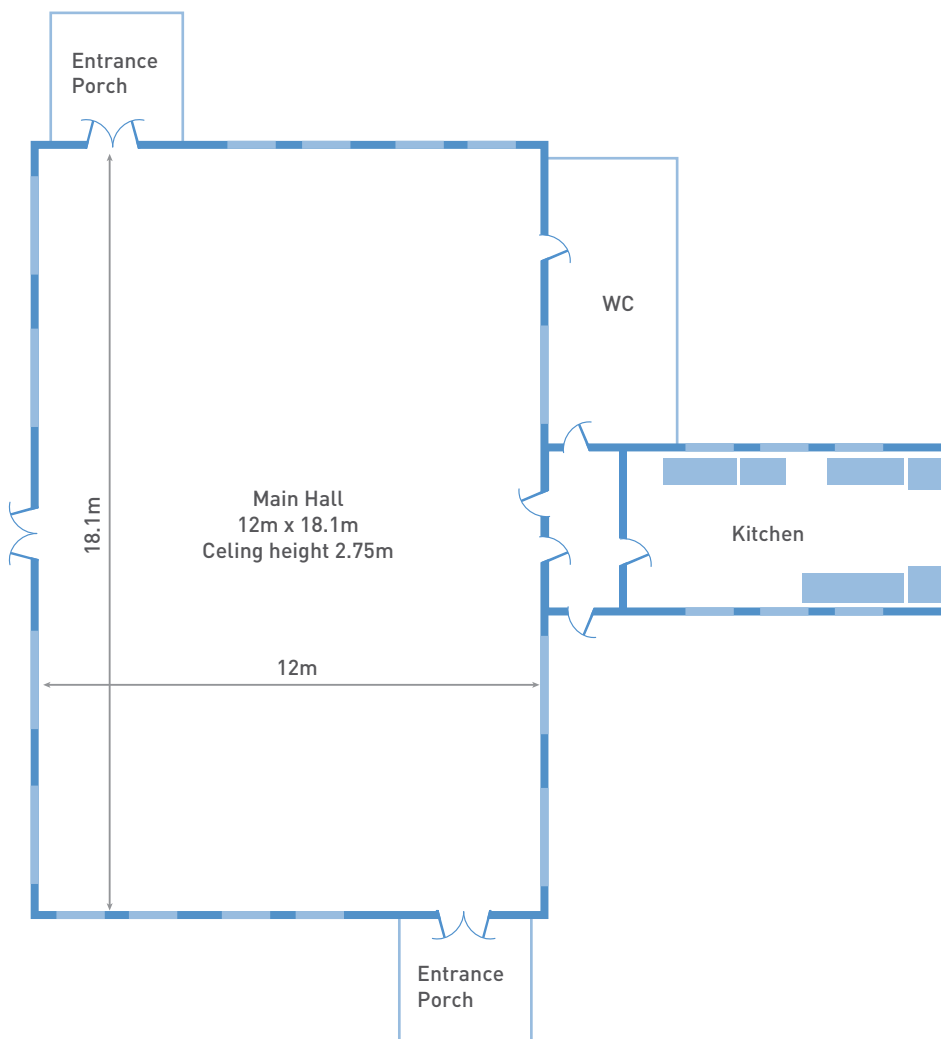

Flexible space and the combination of the Malvern Hills and the Midlands location means it's a picturesque, accessible venue.

David Jacobmeyer,
Managing Director of
Energy Expo Now



Price List

- ✓ Day Delegate rates from as little as **£25 per head***
- ✓ Hire Teme Hall from **£800**

Please call 01684 584924 for further information

** Prices subject to individual requirements and numbers. We offer flexible, tailor-made packages and multi-day discounts to suit your business budget.*